

PAVERS

DRIVEWAYS, PERMEABLE DRIVEWAYS & PATIOS







PHYSICAL AND GEOMETRICAL CHARACTERISTICS

CHARACTERISTICS	ASTM C936
Compressive strength	8000 psi [55 MPa] min.
Absorption	5 % max.
Resistance to freezing and thawing	Mass loss (max.): 225 g/m ² at 28 cycles 500 g/m ² at 49 cycles
Dimensional tolerance	Length and Width: ± 0.063 in. [1.6 mm] Thickness: ± 0.125 in. [3.2 mm]

Notes : Dimensional tolerances prior to the application of architectural finishes.

INSTALLATION GUIDE

TYPICAL APPLICATION USAGE

SECTOR	TRAFFIC TYPE & APPLICATIONS	PAVERS
RESIDENTIAL	 <p>1. Light traffic Cars and occasional light service trucks (ex. residential driveways)</p>	<ul style="list-style-type: none"> - Allegro - Antika - Aquastorm - Athena - Blu 80 mm - Blu 80 mm (6 x 13) - Eva - Hera (square & rectangle) - Linea (small rectangles) - Mika - Mista Grande - Mista Random - Mista Square - Parisien (square, rectangle, circle) - Squadra - Travertina Raw - Valet - Victorien 60 mm - Villagio - All products from traffic type 2 & 3.
	 <p>2. Road traffic Cars, heavy trucks, buses (ex. boulevards, main or secondary streets, pedestrian crossings, industrial, ports and airport areas)</p>	<ul style="list-style-type: none"> - Industria 200 x 200 - Industria 300 x 100 - Industria 300 x 150 - Industria 300 x 300
ICI (Industrial, Commercial and Institutional)	 <p>3. Light traffic Cars and occasional light service trucks (ex. parking lots, sidewalks)</p>	<ul style="list-style-type: none"> - Aquastorm - Industria 200 x 400 - Industria 600 x 300 - Industria 600 x 600 - Linea (large rectangles) - All product from traffic type 2.
	 <p>4. Pedestrian Pedestrian only and at all times, without cars, or trucks or other mobile equipment (ex. terraces, parks, pedestrian walkways)</p>	<ul style="list-style-type: none"> - Aquastorm - Blu 80 mm (6 x 13) - Industria 600 x 100 - Industria 600 x 200 - Linea (small rectangles) - All product from traffic type 2 & 3.

INSTALLATION GUIDE

INTERLOCKING CONCRETE PAVEMENT

INSTALLATION OUTLINE

01 EXCAVATION

- A. Before excavating, call all the local utility companies (e.g., phone, gas, electrical) to ensure that the area in which you plan to dig is clear of underground cables or wires. If any are found, please notify the appropriate companies before you begin.
- B. When excavating, it is important to achieve a slope in increments of 1.5% ($\frac{3}{16}$ " per ft/5 mm per 300 mm), which will allow for proper drainage. The excavation should mirror the final grade of pavement.
- C. The width of the base behind the edge should be equivalent to the thickness of the base.
- D. Using a rake, grade the bottom of the excavated area. If the natural soil is granular or sandy, we recommend that you compact the soil with a vibrating plate. If the soil is clay-like, change the soil with a blend of lime and crushed stone prior to compaction. Next, cover it with a layer of geotextile fabric to prevent the contamination of the base (clay and 0- $\frac{3}{4}$ " [0-20 mm] crushed stone). Refer to the table "**Thickness of the Granular Foundation**" (on next page) to find the minimum thickness of foundation required.

02 FOUNDATION

- A. Install a 0- $\frac{3}{4}$ " (0-20 mm) crushed stone base, in 4" (100 mm) lifts with a minimum 5,000 lbf (22 kN) vibrating plate compactor.
- B. To facilitate compacting, wet the base material thoroughly and compact with a vibrating plate proceeding in all directions. Continue this process until you have achieved the desired height. At this stage, you can verify the final height with the help of a paver.
- C. Base tolerance $\pm\frac{3}{8}$ " (10 mm) for every 10' (3-m) increment.

03 THE SETTING BED

- A. On the compacted crushed base, install two pipes with an outside diameter of 1" (25 mm). Grade the concrete sand with the help of a straight edge (or Quick-E leveler). If the base is not properly graded and smooth, imperfections will be evident in the finishing grade of the pavement.
- B. Bedding sand should not be compacted until all paving stones have been laid down. Passing the vibrating plate over the paving stones causes them to settle approximately $\frac{3}{8}$ " (10 mm) into the bedding sand.

04 INSTALLATION OF PAVING STONES

- A. Once the choice of paving stones and the design have been finalized, we recommended that you start installing the pavers at a 90-degree angle. To do so, proceed as follows: measure a first horizontal line of 3' (1-m) and a second line of 4' (1.2 m) perpendicular to the first. Connect a third straight line of 5' (1.5 m) which will form a triangle. The result will be a perfect 90-degree angle. While installing the paving stones, walk on the installed pavers, and fill in gaps caused by the pipes with concrete sand.
- B. It is always recommended that you use more than two cubes at a time in order to maximize the color blend. Furthermore, you should proceed with the cubes from top to bottom.
- C. You may use a chalk line to mark the stones to be cut along the borders, using a guillotine or a concrete saw. When cutting paving stones, we recommend that you wear protective ear and eyewear.
- D. Once you finish installing the paving stones, you can then install Tundra, Avignon, Belgik or Pietra curbstone on the granular base. To keep curbs in place, add mortar along the back to form a 45-degree angle between the ground and the curbstone or, when available, using the plastic retention system. In a vehicular traffic application, the mortar must be reinforced using steel rods.

05 FILLING IN JOINTS

- A. Spread out the polymer stabilizer sand on the paving stones and sweep in between joints in all directions.
- B. Pass a vibrating plate in all directions to allow sand to penetrate between the joints.
- C. Sweep once more and remove excess sand. Follow the instructions exactly as indicated on the polymer stabilizer sand packaging.

INSTALLATION GUIDE

INTERLOCKING CONCRETE PAVEMENT



VIBRATING PLATE ALERT!

Avoid scuffs on paver surfaces. Pavers with embossed surfaces (high and low points) are more susceptible to scuff marks from plate compactors. Techo-Bloc recommends the use of urethane mats between the plate and the paver surface when compacting. Techo-Bloc will not be held responsible for compaction scuffs or burns on pavers.

THICKNESS OF THE GRANULAR FOUNDATION¹

RESIDENTIAL PROJECTS	TYPE OF EXISTING SOIL	
	Clayey or Silty ²	Sandy or Gravelly
Driveways	8" to 14" (200 to 350 mm)	6" to 10" (150 to 250 mm)
Patios and Walkways	6" to 8" (150 to 200 mm)	4" to 6" (100 to 150 mm)

1. Data shown in this chart are provided as guidelines only. The range of values suggested depends particularly on existing soil conditions. The thicker the granular foundation, the greater the increase in stability of the whole structure.
2. In the case of unstable soils or ones particularly affected by the freeze-thaw cycles, a thicker foundation may be necessary. For soils with these conditions or for commercial, industrial, or institutional works, a geotechnical professional should be consulted.

QUANTITY CHART FOR JOINTS FILLING Approximate surface coverage per 50 lbs (22.7 kg) polymeric sand bag.

PRODUCTS	sq. ft	sq. m
Allegro	38	3.5
Antika	21	2
Athena	42	4
Blu 80 mm	76.5	7.11
Blu 80 mm (6"×13")	31.97	2.97
Eva	143.56	13.34
Hera square	81.16	7.54
Hera rectangle	101.24	9.41
Industria 200 series - 200×200	41.03	3.81
Industria 200 series - 200×400	54.57	5.07
Industria 300 series - 300×100	30.77	2.86
Industria 300 series - 300×200	41	3.81
Industria 300 series - 300×300	61.39	5.70
Industria 600 series - 600×100	35.06	3.26
Industria 600 series - 600×200	61.32	5.70
Industria 600 series - 600×300	81.72	7.59
Industria 600 series - 600×600	122.48	11.38
Linea small rectangles	31.47	2.92
Linea large rectangles	42.33	3.93
Mika	16.41	1.53
Mista random	50.4	4.69
Mista square	65.6	6.10
Mista Grande	25.67	2.38
Parisien square	100.64	9.35
Parisien rectangle	120.55	11.20
Parisien circle	49.25	4.58
Squadra	14.50	1.35
Travertina Raw	16.41	1.53

Valet	24.1	2.2
Victorien 60 mm	97.06	9.02
Villagio	18.50	1.72

Topsoil quantity in lb (kg) to cover an area of 1 sq.ft (1 sq.m) to fill in between joints and the paver cavity.

PRODUCTS	lbs/sq. ft	kg/sq. m
Aquastorm	12.60	61.40

TYPICAL PAVER CROSS SECTION WITH PLASTIC EDGE

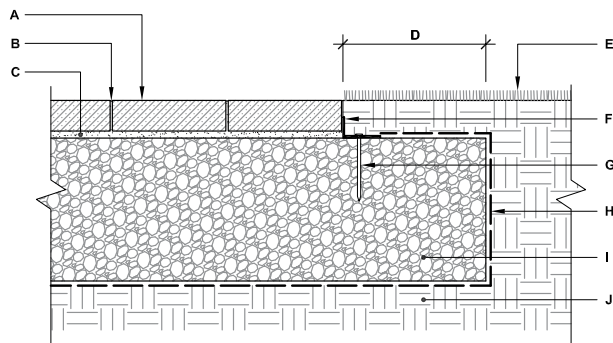

- A. TECO-BLOC PRECAST CONCRETE PAVER 2 3/8" (60 mm) THICK MIN.
- B. SAND JOINT FILL
- C. SAND SETTING BED (CONCRETE SAND) 1" (25 mm)
- D. EXTRA WIDTH EQUAL TO FOUNDATION THICKNESS
- E. LAWN
- F. PLASTIC EDGE
- G. NAIL
- H. GEOTEXTILE
- I. COMPACTED GRANULAR BASE 0-3/4" (0-20 mm)
- J. SUBGRADE

INSTALLATION GUIDE

AQUASTORM - CAVITY INFILL

GRASS INFILL

Cross section

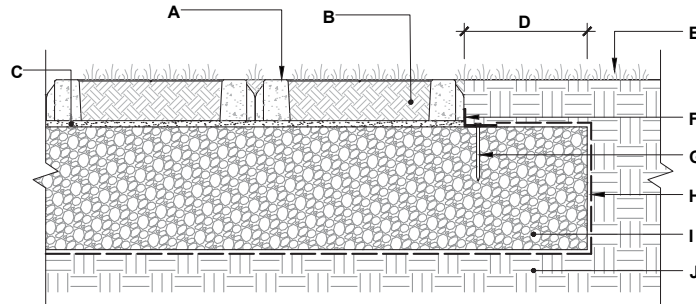

- A. TECO-BLOC AQUASTORM PRECAST CONCRETE PAVER
3¹⁵/₁₆" (100 mm) THICK.
- B. TOPSOIL INFILL (CAVITIES AND JOINTS)
- C. SAND SETTING BED (CONCRETE SAND) 1" (25 mm)
- D. EXTRA WIDTH EQUAL TO FOUNDATION THICKNESS
- E. LAWN
- F. PLASTIC EDGE
- G. NAIL
- H. GEOTEXTILE
- I. COMPACTED GRANULAR BASE 0-3/4" (0-20 mm)
- J. SUBGRADE

AGGREGATE INFILL

Cross section

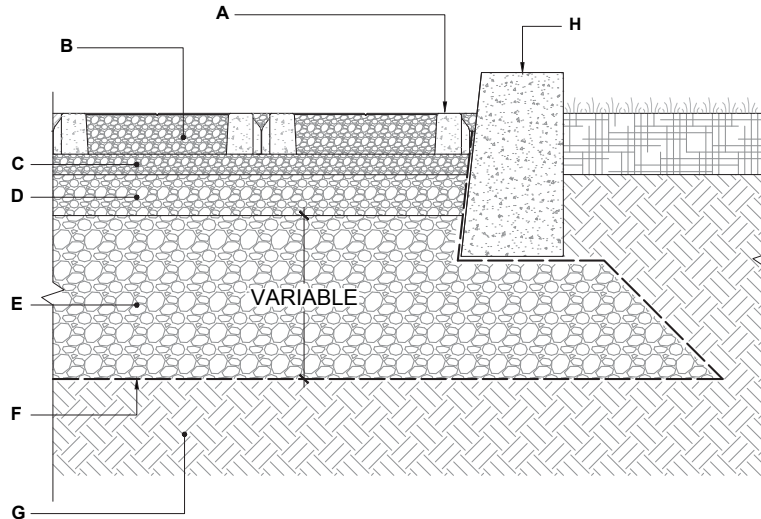

- A. TECO-BLOC AQUASTORM PERMEABLE PAVER
3¹⁵/₁₆" (100 mm) THICK.
- B. JOINTS AND CAVITIES FILLING MATERIAL
ASTM No 8 (CSA 2.5-10 mm) AGGREGATE
- C. BEDDING COURSE 1 1/2" TO 2" (40 TO 50 mm)
ASTM No 8 (CSA 2.5-10 mm) AGGREGATE
- D. BASE COURSE 4" (100 mm)
ASTM No 57 (CSA 5-28 mm) AGGREGATE
- E. SUBBASE COURSE
ASTM No 2 (CSA 40-80 mm) AGGREGATE
- F. GEOTEXTILE
- G. SUBGRADE
- H. CONCRETE EDGE

INSTALLATION GUIDE

PARISIEN CIRCLE - LAYING PATTERN

7'-10 1/2" (2.40 M) DIAMETER CIRCLE

Each Parisien Circle pallet comes with a surplus of materials. There are enough pavers in each pallet for 1 full circle of 7'-10 1/2" in diameter. To get a complete circle, be sure to follow the laying order illustrated. In each ring, the repetitive sequence pattern is shown in grey color. When there is a break in the repetitiveness of the sequence, the specific stone is identified with a letter on a white background.

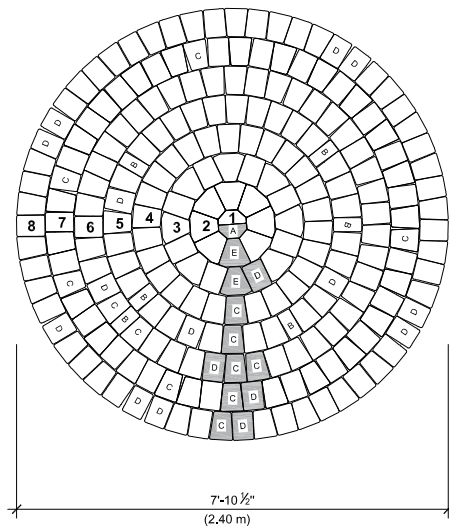

RING	DIAMETER		SURFACE AREA		UNITS				
	ft	m	ft ²	m ²	A	B	C	D	E
1	0'-6 5/16"	0.16	0.22	0.02	2	-	-	-	-
2	1'-6 7/8"	0.48	1.95	0.18	-	-	-	-	8
3	2'-7 1/2"	0.80	5.41	0.50	-	-	-	8	8
4	3'-8 1/8"	1.12	10.60	0.99	-	-	26	-	-
5	4'-8 11/16"	1.44	17.53	1.63	-	5	28	3	-
6	5'-9 5/16"	1.76	26.19	2.43	-	1	28	14	-
7	6'-9 7/8"	2.08	36.57	3.40	-	-	28	23	-
8	7'-10 1/2"	2.40	48.69	4.52	-	-	25	34	-
TOTAL					2	6	135	82	16

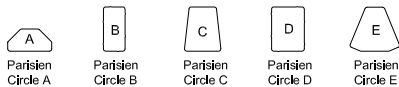

Patterns are for design inspiration only. The installer is responsible to calculate & purchase the correct amount of material.

INSTALLATION GUIDE

PARISIEN CIRCLE - LAYING PATTERN

13'-1 1/2" (4.00 M) DIAMETER CIRCLE

The Parisien Circle can be extended up to 13'-1 1/2" (4.00 m) diameter by using (note that there will be a surplus of materials):

- 2 pallets of Parisien Circle
- 1 row of a pallet of Parisien Square
- 3 rows of a pallet of Parisien Rectangle

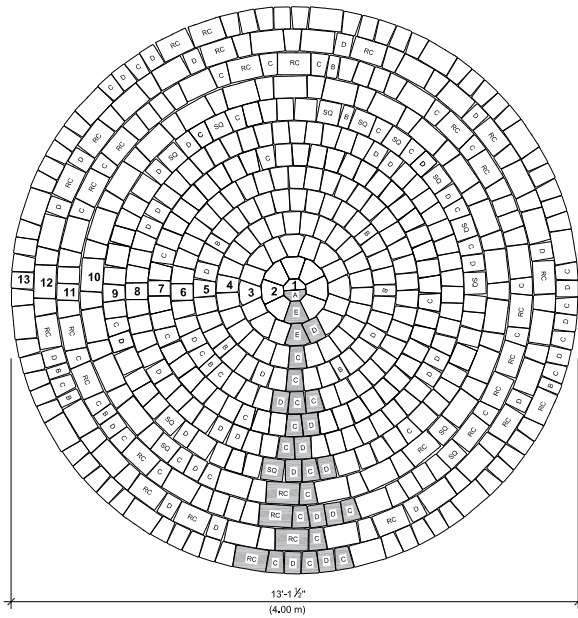

To get a complete circle, be sure to follow the laying order illustrated. In each ring, the repetitive sequence pattern is shown in grey color. When there is a break in the repetitiveness of the sequence, the specific stone is identified with a letter on a white background.

Patterns are for design inspiration only. The installer is responsible to calculate & purchase the correct amount of material.

RING	DIAMETER		SURFACE AREA		UNITS						
	ft	m	ft ²	m ²	A	B	C	D	E	SQ	RC
1	0'-6 5/16"	0.16	0.22	0.02	2	-	-	-	-	-	-
2	1'-6 7/8"	0.48	1.95	0.18	-	-	-	-	8	-	-
3	2'-7 1/2"	0.80	5.41	0.50	-	-	-	8	8	-	-
4	3'-8 1/8"	1.12	10.60	0.99	-	-	26	-	-	-	-
5	4'-8 11/16"	1.44	17.53	1.63	-	5	28	3	-	-	-
6	5'-9 5/16"	1.76	26.19	2.43	-	1	28	14	-	-	-
7	6'-9 7/8"	2.08	36.57	3.40	-	-	28	23	-	-	-
8	7'-10 1/2"	2.40	48.69	4.52	-	-	25	34	-	-	-
9	8'-11 1/16"	2.72	62.54	5.81	-	1	17	25	-	18	-
10	9'-11 11/16"	3.04	78.13	7.26	-	-	25	1	-	2	24
11	11'-0 5/16"	3.36	95.44	8.87	-	2	28	15	-	1	20
12	12'-0 7/8"	3.68	114.48	10.64	-	2	20	11	-	-	30
13	13'-1 1/2"	4.00	135.26	12.57	-	1	42	29	-	-	15
TOTAL					2	12	267	163	16	21	89

PERMEABLE PAVERS

DRIVEWAYS, PERMEABLE DRIVEWAYS & PATIOS







PHYSICAL AND GEOMETRICAL CHARACTERISTICS

CHARACTERISTICS	ASTM C936
Compressive strength	8000 psi [55 MPa] min.
Absorption	5 % max.
Resistance to freezing and thawing	Mass loss (max.): 225 g/m ² at 28 cycles 500 g/m ² at 49 cycles
Dimensional tolerance	Length and Width: ± 0.063 in. [1.6 mm] Thickness: ± 0.125 in. [3.2 mm]

Notes : Dimensional tolerances prior to the application of architectural finishes.

INSTALLATION GUIDE

TYPICAL APPLICATION USAGE

SECTOR	TRAFFIC TYPE & APPLICATIONS	PERMEABLE PAVERS
RESIDENTIAL	 <p>1. Light traffic Cars and occasional light service trucks (ex. residential driveways)</p>	<ul style="list-style-type: none"> - Antika - Aquastorm - Blu 80 mm - Inflo - Mika - Mista Random - Pure - Travertina Raw - Valet - Victorien 60 mm permeable - Villagio
	 <p>2. Pedestrian Pedestrian only and at all times (ex. patios)</p>	<ul style="list-style-type: none"> - Antika - Aquastorm - Blu 80 mm - Blu 60 mm - Inflo - Mika - Mista Random - Pure - Travertina Raw - Valet - Victorien 60 mm permeable - Villagio
ICI (Industrial, Commercial and Institutional)	 <p>3. Road traffic Cars, heavy trucks, buses (ex. boulevards, main or secondary streets, pedestrian crossings, industrial, ports and airport areas)</p>	<ul style="list-style-type: none"> - Inflo
	 <p>4. Light traffic Cars and occasional light service trucks (ex. parking lots, sidewalks)</p>	<ul style="list-style-type: none"> - Aquastorm - Inflo - Pure
	 <p>5. Pedestrian Pedestrian only and at all times, without cars, or trucks or other mobile equipment (ex. terraces, parks, pedestrian walkways)</p>	<ul style="list-style-type: none"> - Aquastorm - Inflo - Pure

INSTALLATION GUIDE

INFILTRATION CHART

PERMEABLE PAVERS	PERCENT OF SURFACE OPENING (%)	JOINT WIDTH (mm)	INFILTRATION RATE ¹ (mm/h)
ANTIKA ²	Variable	Variable	993 in./hr (25 227 mm/hr)
AQUASTORM	38.4	1 5/8" (41 mm)	To come
BLU 80 mm ²	3.0	9/32" (7 mm)	570 in./hr (14 475 mm/hr)
BLU 80 mm (6x13) ²	4.6	9/32" (7 mm)	570 in./hr (14 475 mm/hr)
INFLO ¹	5.8	1/2" (13 mm)	837 in./hr (21 267 mm/hr)
MIKA	7.8	5/8" (15 mm)	To come
MISTA RANDOM ¹	6.3	3/16" (4 mm) to 9/16" (14 mm)	610 in./hr (15 505 mm/hr)
PURE ²	5.0	3/8" (10 mm)	726 in./hr (18 440 mm/hr)
TRAVERTINA RAW	7.8	5/8" (15 mm)	To come
VALET	5.9	9/32" (7 mm)	To come
VICTORIEN 60 mm PERMEABLE ¹	9.6	3/8" (10 mm)	909 in./hr (23 085 mm/hr)
VILLAGIO ¹	8.0	3/8" (9 mm) to 9/16" (15 mm)	896 in./hr (22 750 mm/hr)
PERMEABLE SLABS	PERCENT OF SURFACE OPENING (%)	JOINT WIDTH (mm)	INFILTRATION RATE ¹ (mm/h)
BLU 60 mm ²	3.0	9/32" (7 mm)	570 in./hr (14 475 mm/hr)
BLU 60 mm (6x13) ²	4.6	9/32" (7 mm)	570 in./hr (14 475 mm/hr)

¹Measurements were taken at various sites in conformity to the standard ASTM C 1701-09.

²Measurements were taken at various sites in conformity to the standard ASTM C 1781.

OTHER PERMEABLE POSSIBILITIES

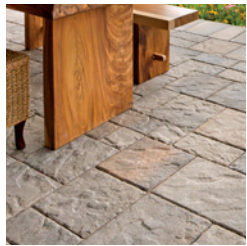

**BLU 60 MM
SLAB**

(page 23 to 27)



**AQUASTORM
PAVER**

(page 50)



**ANTIKA
PAVER**

(page 49)



**BLU 80 MM
PAVER**

(page 53 to 56)



**MIKA
PAVER**

(page 70)

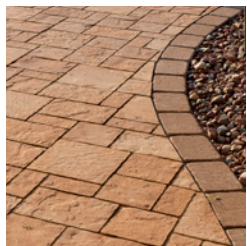

**MISTA RANDOM
PAVER**

(page 72)



**TRAVERTINA RAW
PAVER**

(page 79)



**VALET
PAVER**

(page 80)



**VILLAGIO
PAVER**

(page 82)

INSTALLATION GUIDE

SEGMENTAL PERMEABLE PAVEMENT



INSTALLATION OUTLINE

01 DATA COLLECTION

- A. Determine the size, shape, and intended use of finished areas (i.e. residential driveway, secondary commercial parking, etc.).
- B. Classify sub-grade soils.
- C. Document all existing conditions (i.e. fixed points, existing grades, site contours, etc.).
- D. Document soil type, location, and elevation of below grade and overhead utilities both public and private.
- E. Ensure public utilities are marked through the use of a locating service.
- F. Determine the cross section design of the system based on soil type and application, showing proposed sub-grade and finished grade elevations and all geotextiles and drainage pipes needed for the construction.
- G. Establish the type, location, and elevation of relief structures if required (i.e. overflow pipe discharging to rain garden, etc.).
- H. Determine the curb or edge restraint type, elevation, and location.
- I. Choose a pattern appropriate to the application (traffic type and load).

02 EXCAVATION

- A. Before digging, contact the concerned companies if wires or pipes are located in the area to be excavated.
- B. Excavation depth is determined from the foundation thickness according to the project specifications (foundation thickness is determined by a qualified engineer based on structural and hydrological analyses).
- C. Although the slope of the sub-grade will depend on the drainage design and infiltration type, a minimum slope of 0.5% ($\frac{1}{16}$ " per ft, or 5 mm per meter) is recommended.
- D. The distance that the excavated area should extend beyond the area to be paved should be one to 1.5 times the thickness of the foundation. This extra space will ensure the stability of the pavers near the edge and the edge restraints.
- E. Level the bottom of the excavated area with a rake.

Compaction will reduce the permeability of the sub-grade and it should be executed according to the project specifications. If compaction is not specified, care should be taken to maintain undisturbed soil infiltration during excavation and construction. Stabilization of the sub-grade may be required with weak, continually saturated soils, or when subject to high traffic conditions. If the compaction or stabilization of sub-grade is necessary, reduced infiltration may require drainage pipes within the sub-base to conform to storm water drainage requirements.

03 GEOTEXTILE, IMPERMEABLE LINERS, AND DRAIN PIPES

- A. Use the geotextile specified and install it according to project specifications. The use of a woven geotextile with bi-axel strength that meets design criteria is recommended.
- B. Place the geotextile on the bottom and sides of the soil sub-grade. Eliminate wrinkles in the geotextile and ensure it is not damaged during construction.
- C. Overlap of geotextile should be a minimum of 2' (600 mm) in the direction of drainage. Overlapping should be "shingle" style with respect to any slope direction and base stone distribution direction. Keep properly tensioned, eliminate wrinkles, and avoid damaging fabric (no spikes).
- D. If impermeable liners are required, install them according to project specifications and manufacturer's instructions. Impermeable liners are used when full exfiltration from the reservoir (sub-base and base) into the underlying sub grade is not allowed (no infiltration design). Perforated drainage pipes are usually required in no infiltration and partial infiltration designs.
- E. If drainage pipes are required, install them according to project specifications. The aggregate cover over drainage pipes should be at least 12" (300 mm) to protect them from damage during sub-base or base compaction.

INSTALLATION GUIDE

SEGMENTAL PERMEABLE PAVEMENT

04 SUB-BASE

For residential pedestrian applications, the sub-base may not be required and then only ASTM No. 57 (CSA 5-28) aggregate base layer with a minimum thickness of 6" (150 mm) can be used (use a thicker base for additional water storage). Refer to Base (see below 06).

When traffic load, soil conditions, and climate require greater than 12" (300 mm) of base or volume requirements for detention are higher, a sub-base may be required. Use sub-base ASTM No. 2 or No. 3 (CSA 40-80) meeting the following requirements:

- 90% fractured symmetrical particles
 - Less than 5% passing the 200 sieve
 - Industry hardness tested
- A. Moisten, spread and compact the ASTM No. 2 (CSA 40-80) aggregate sub-base in minimum 6" (150 mm) lifts (without distorting or damaging the geotextile) according to the project specifications.
 - B. Make at least two passes in the vibratory mode followed by at least two passes in the static mode with a minimum 10 ton (9 metric ton) vibratory roller, until there is no visible movement of the aggregate. Alternately, a 13,500 lbf (60 kN) plate compactor can be used to compact the ASTM No. 2 (CSA 40-80) aggregate sub-base.
 - C. Do not allow the compactor to crush the aggregate.
 - D. Surface tolerance of the ASTM No. 2 (CSA 40-80) sub-base should be $\pm 2 \frac{1}{2}$ " (64 mm) over 10' (3 m).

05 EDGE RESTRAINT

- A. Install edge restraint according to project specifications.
- B. Depending on the design, the top of the edge restraint can be hidden or exposed.
- C. Install Avignon, Belgik, Pietra, Tundra or Universal edge units. Cast-in-place concrete or precast concrete curbs should be considered in vehicular use applications (commercial / industrial driveways, parking lots or streets).
- D. Edge restraint may rest on an open-graded or dense-graded aggregate base.

06 BASE

- A. Moisten, spread and compact the ASTM No. 57 (CSA 5-28) aggregate base layer in one 4" (100 mm) thick lift.
- B. Make a minimum of two passes in vibratory mode followed by at least two in static mode with a minimum 10 ton (9 metric ton) vibratory roller, until there is no visible movement of the aggregate. Alternately, a 13,500 lbf (60 kN) plate compactor can be used to compact the ASTM No. 57 (CSA 5-28) aggregate base.
- C. Do not allow the compactor to crush the aggregate.
- D. Surface tolerance of the ASTM No. 57 (CSA 5-28) base should be ± 1 " (25 mm) over 10' (3 m). Verify prior to setting bed installation.

07 BEDDING COURSE

- A. Moisten, spread and screed the ASTM No. 8 (CSA 2.5-10) aggregate bedding layer in one 2" (50 mm) thick lift.
- B. Surface tolerance of the ASTM No. 8 (CSA 2.5-10) bedding course should be $3 \frac{3}{8}$ " (10 mm) over 10' (3 m).
- C. Construction equipment and pedestrian traffic on the screeded bedding course should not be permitted.

08 PAVER

- A. Pavers should be placed in the pattern shown on the drawings. Lay units hand tight to designated laying patterns. Units have lugs to maintain consistent joint width.
- B. In sloped conditions, it is preferable to start laying from the bottom in an uphill direction.
- C. The minimum slope recommended for permeable pavement surface is 1%.
- D. Inflow pavers can be installed with the TB100SI (Techo-Bloc mechanical tool) to expedite installation.
- E. When subject to vehicular traffic, cut units should not be smaller than $\frac{1}{3}$ of a whole paver. When using cut pieces, maintain joint.
- F. In vehicular applications, pattern strength will increase if laying pattern is perpendicular to traffic flow.

INSTALLATION GUIDE

SEGMENTAL PERMEABLE PAVEMENT

09 JOINT FILL

- A. Fill the paver joint openings with ASTM No. 8 (CSA 2.5-10) aggregate (or No. 89, No. 9 depending on joint width). Sweep stone to fill joints. Surface must be swept clean prior to compaction.
- B. Compact with a minimum 5,000 lbf (22 kN) plate compactor (two passes minimum). The installation of a neoprene pad is recommended to protect the texture of the paving units.
- C. Do not compact within 6' (1.8 m) of unrestrained edges of the pavers.
- D. Apply additional aggregate to fill the joint openings if needed and compact.
- E. Surface tolerance of compacted pavers should be $\pm 3/8"$ (10 mm) over 10' (3 m).

APPROXIMATE MEASURES

Clean stone quantity in kg (lb) to cover an area of 1 m² (1 pi²) to fill between joints.
It is recommended to always start with a small area.

PRODUCTS	JOINT FILL MATERIAL	(lbs/sq. ft)	(kg/sq. m)
Antika	ASTM No. 8 (CSA 2.5 - 10) (1/4")	1.9	9.3
Aquastorm	ASTM No. 8 (CSA 2.5 - 10) (1/4")	12.2	59.5
Blu 60 mm	ASTM No. 9 (CSA 2.5 - 5) (1/8")	0.6	3.0
Blu 60 mm (6x13)	ASTM No. 9 (CSA 2.5 - 5) (1/8")	0.9	4.2
Blu 80 mm	ASTM No. 9 (CSA 2.5 - 5) (1/8")	0.8	4.0
Blu 80 mm (6x13)	ASTM No. 9 (CSA 2.5 - 5) (1/8")	1.2	5.7
Inflo	ASTM No. 8 (CSA 2.5 - 10) (1/4")	2.1	10.3
Mika	ASTM No. 8 (CSA 2.5 - 10) (1/4")	2.5	12.2
Mista random	ASTM No. 9 (CSA 2.5 - 5) (1/8")	1.0	5.0
Pure	ASTM No. 9 (CSA 2.5 - 5) (1/8")	1.4	7.0
Travertina Raw	ASTM No. 8 (CSA 2.5 - 10) (1/4")	2.5	12.2
Valet	ASTM No. 9 (CSA 2.5 - 5) (1/8")	1.3	6.2
Victorien 60 mm permeable	ASTM No. 9 (CSA 2.5 - 5) (1/8")	1.7	8.5
Villagio	ASTM No. 8 (CSA 2.5 - 10) (1/4")	2.1	10.2

10 POST INSTALLATION PROTECTION

Prevent contamination of the porous (permeable) pavement system from fine aggregates and debris by maintaining erosion and sedimentation (E&S) measures at the perimeter.

INSTALLATION GUIDE

SEGMENTAL PERMEABLE PAVEMENT

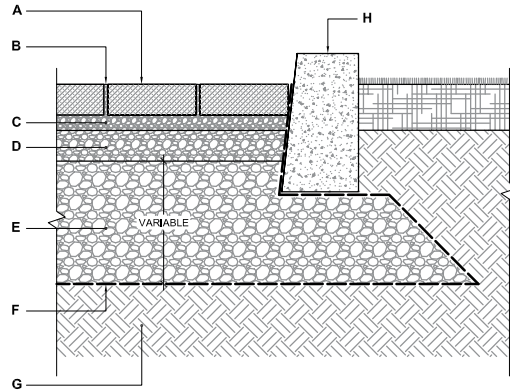

- A. PERMEABLE PAVER FROM TECO-BLOC
- B. JOINT FILLING MATERIAL
ASTM No 8 (CSA 2.5-10 mm) AGGREGATE
- C. BEDDING COURSE 1½" to 2" (40 to 50 mm)
ASTM No 8 (CSA 2.5-10 mm) AGGREGATE
- D. BASE COURSE 4" (100 mm)
ASTM No 57 (CSA 5-28 mm) AGGREGATE
- E. SUBBASE COURSE
ASTM No 2 (CSA 40-80 mm) AGGREGATE
- F. GEOTEXTILE
- G. SUBGRADE
- H. CONCRETE EDGE

SEGMENTAL PERMEABLE PAVEMENT – FULL INFILTRATION

Typical cross section

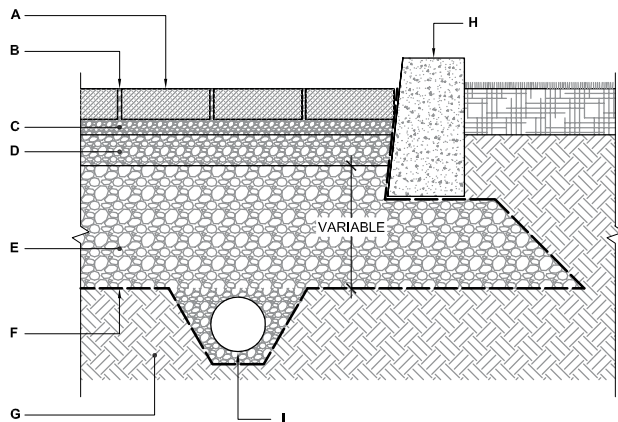

- A. PERMEABLE PAVER FROM TECO-BLOC
- B. JOINT FILLING MATERIAL
ASTM No 8 (CSA 2.5-10 mm) AGGREGATE
- C. BEDDING COURSE 1½" to 2" (40 to 50 mm)
ASTM No 8 (CSA 2.5-10 mm) AGGREGATE
- D. BASE COURSE 4" (100 mm)
ASTM No 57 (CSA 5-28 mm) AGGREGATE
- E. SUBBASE COURSE
ASTM No 2 (CSA 40-80 mm) AGGREGATE
- F. GEOTEXTILE
- G. SUBGRADE
- H. CONCRETE EDGE
- I. PERFORATED DRAIN CONNECTED TO DRAINAGE SYSTEM

SEGMENTAL PERMEABLE PAVEMENT – PARTIAL INFILTRATION

Typical cross section

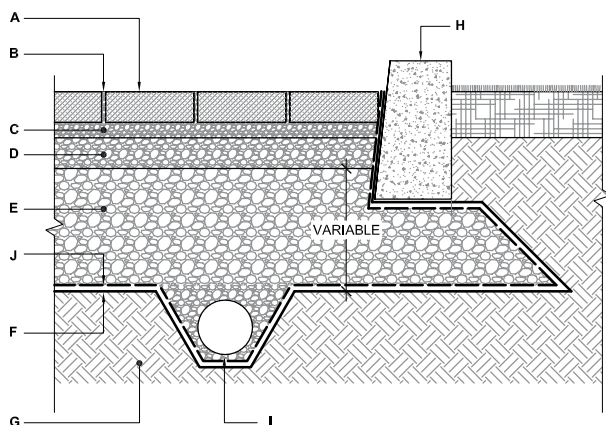

- A. PERMEABLE PAVER FROM TECO-BLOC
- B. JOINT FILLING MATERIAL
ASTM No 8 (CSA 2.5-10 mm) AGGREGATE
- C. BEDDING COURSE 1½" to 2" (40 to 50 mm)
ASTM No 8 (CSA 2.5-10 mm) AGGREGATE
- D. BASE COURSE 4" (100 mm)
ASTM No 57 (CSA 5-28 mm) AGGREGATE
- E. SUBBASE COURSE
ASTM No 2 (CSA 40-80 mm) AGGREGATE
- F. IMPERMEABLE MEMBRANE
- G. SUBGRADE
- H. CONCRETE EDGE
- I. PERFORATED DRAIN CONNECTED TO DRAINAGE SYSTEM

SEGMENTAL PERMEABLE PAVEMENT – NO INFILTRATION

Typical cross section